

OSCAR SERIES



SEGASiT ©

The leading Turkish brand of quality Auditorium, Theatre and Cinema Seating



OSCAR-Line



OSCAR series auditorium seating is manufactured in accordance with the needs of conference and theater halls and also in ergonomic designs targeting comfort that fits the audience perfectly.

The series is in line with the needs of the investor and the audience; it is enriched with central legs, upholstered fabric or leather upholstery, backrest, and seat units wooden cover.

The combination of design and comfort makes the series of auditorium chairs the ideal choice to equip Auditorium and Theater Halls, Conference and Convention Centers, Performing Arts Centers, Corporate and Public Building Halls, Education and School Halls.

OSCAR-Round



DIMENSIONS (mm)

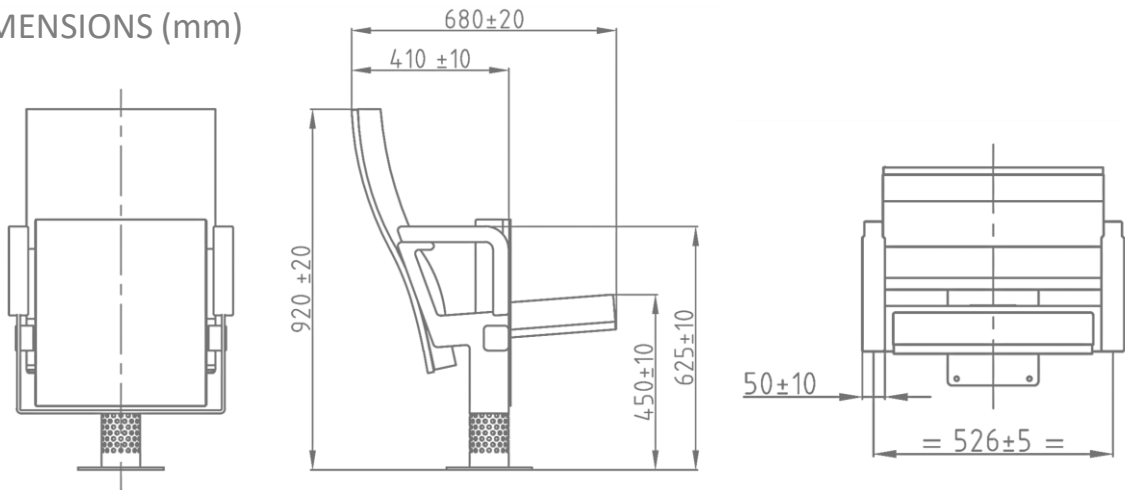

CHARACTERISTIC FEATURES

- (MW) The feet are steel plate supported with a central leg, finished with a solid wooden armrest unit.
- (BSW) Both backrest and seat padding are supported by a varnished beech plywood backboard.

OSCAR Line | MW-BSW

Dimensions

- Centre-to-Centre dimension is 53 cm.
- The nominal space for user is 48 cm.

Seat and Backrest units

- All paddings are produced with cold moulded CMHR polyurethane foam technology,
- Both backrest and seat padding has a carefully crafted ergonomic design, density 50-60 kg/m³.
- The seat padding is a single block of molded polyurethane foam that incorporates an internal metal frame structure.
- The backrest padding is a single block of molded polyurethane foam that incorporates an internal metal frame structure which, due to its shape and composition, offers great back and lumbar support.
- Upholstered with padded cover, removable by means of a zipper.
- The fully upholstered backrest and seat padding are incorporated with a 12 mm thick varnished beech plywood backboard
- Tip-up seat folds automatically with inside weight balance system. Totally silent and maintenance free.

Armrests

- Fixed and shared armrest with a curved design.
- Made of decorative varnished beech solid wooden.

Structure

- The metal mainframe as a single piece is made of an 8 mm thick U shape steel plate that is supported with a central leg made of perforated cylinder steel tube designed and produced to provide durability and long life.
- The central leg is joined to a 6 mm thick steel base and fixed to the floor using metric screws or other suitable types of anchorage for each type of surface.
- The fully upholstered backrest padding, which is joined to a metal structure, is fixed to the metal mainframe with a concealed insertion system that provided strong durability.
- The system is very resistant and ensures the perfect alignment of the backrests when forming a row.
- The metal parts are painted electrostatic powder paint. Coat thickness 80 microns \pm 10.

Options

- Seat, row numbering and logo embroidery.
- Variety of foam density.
- Variety of fabrics with abrasion, fading and non-flammability characteristics.
- Variety of high-quality faux and genuine leather.

CERTIFIED PRODUCTION

In our production plant we have implemented the quality management system ISO 9001:2015, the environmental management systems ISO 14001:2015, the safety management system OHSAS 18001:2007 are standard.

This brochure supersedes and replaces all previous issues.

All designs, images and illustrations contained within this brochure remain the copyright of SEGASit.

All trademarks, product names and codes detailed within this brochure are the property of SEGASit.

SEGASit ©

www.segasit.com